

PLATE-M

AKSIJALNI VENTILATOR MONTIRAN NA PLOČU SA "IEC" MOTOROM

PLATE MOUNTED AXIAL FAN WITH "IEC" MOTOR



APLIKACIJE

Seriya PLATE-M je dizajnirana za instalacije koje zahtevaju velike kapacitete sa niskim pritiskom, za primenu na zid ili panele. Na primer: ventilacija komercijalnih i industrijskih zgrada, parkinga, stočarskih farmi, hlađenje električnih i rashladnih uređaja itd.

DOMET

Seriya se sastoji od 10 veličina sa prečnikom radnog kola od 250 do 800 mm.

GLAVNE KARAKTERISTIKE

Seriya PLATE-M karakteriše se svestranošću i konkurentnim cenama, što je posledica preciznog dizajna i izbora materijala: impeler je sastavljen od čvrste glavčine od livenog aluminijuma i lopatica izlivenih od različitih materijala pogodnih za teške uslove rada. Motor je proizveden u skladu sa IEC standardima, što garantuje pouzdanost i dugoročni ekonomski oporavak ventilatora zamenom ili popravkom samog motora.

KONSTRUKCIJA

- Noseći okvir sa širokim ulazom u obliku materijala otpornog na koroziju i zaštićen od atmosferskih uticaja.
- Nosač motora i sigurnosna mreža na strani motora od čelične žice zaštićena od atmosferskih uticaja, izrađena u skladu sa UNI EN ISO 12499.
- Radno kolo visokih performansi sa lopaticama od aeroprofila, sa promenljivim uglom nagiba od mirovanja od tehnopolimera i glavčinom od livenog aluminijuma. Standardizovano prema UNI ISO 21940-11 standardima.
- Asinhroni elektromotor trofazni ili jednofazni, zaštita IP 55, klasa izolacije F, servis S1, oblik B5, konstrukcija prema IEC / EEC (UNEL-MEC) standardima.
- Raspored 5 (direktna spojnica sa konzolnim radnim kolom).

TEHNIČKE SPECIFIKACIJE

PLATE M (STANDARDNA VERZIJA)

- Vazduh koji se prenosi: čist ili malo prašnjav, neabrazivan.
- Temperatura transportovanog vazduha: -20°C / $+50^{\circ}\text{C}$.
- Napon napajanja:
 - trofazna verzija (T) 400V-3Ph.
 - monofazna verzija (M) 230V-1Ph
- Frekvencija: 50Hz.
- Protok vazduha od motora do radnog kola, položaj A (FMG).

PRIBOR

- Gravitacioni zatvarač (SG)
- Bočna sigurnosna mreža na rotoru (PG-P)
(neophodna za upotrebu na slobodnom vazduhu)
- Odstojnik (SP).
- Servisni prekidač (SW).

NA ZAHTEV

- Verzije bez mreže držača motora.
- Verzije sa radnim kolom sa noževima od livenog aluminijuma.
- Verzije otporne na eksploziju (PLATE-Atex).
- Verzije sa protokom vazduha od radnog kola do motora, položaj B (FGM)

APPLICATIONS

PLATE-M line is designed for installations requiring large capacities with low pressures, in applications for wall or panel fixing. For instance: ventilation of commercial and industrial buildings, car parks, stock farms, cooling of electric and refrigerating equipments, etc.

RANGE

This line consists of 10 sizes with impeller diameter from 250 up to 800 mm.

ADVANTAGES

PLATE-M line is characterized by versatility and competitive prices, consequence of accurate design and material choices: impeller is composed of a sturdy hub in die-cast aluminum alloy and blades moulded in different materials suitable for heavy-duty applications. Motor is manufactured according to IEC standards, guarantying reliability and a long term economic recovery of the fan by replacing or repairing the motor itself.

CONSTRUCTION

- Supporting frame with wide shaped inlet in corrosion proof material or protected against the atmospheric agents.
- Motor support and safety grid, in steel rod manufactured in accordance with UNI EN ISO 12944.
- Impeller with high efficiency airfoil blades in plastic material and hub in die cast aluminum alloy. Variable pitch angle in still position. Balancing according to UNI ISO 21940-11.
- Asynchronous electric motor three or single phase, protection IP 55, class F insulated, service S1, form B5, construction according to IEC / EEC (UNEL-MEC) standards.
- Arrangement 5 (impeller directly coupled to motor shaft).

TECHNICAL SPECIFICATIONS

PLATE - M (STANDARD VERSION)

- Conveyed air: clean, not abrasive.
- Temperature of conveyed air: -20°C / $+50^{\circ}\text{C}$.
- Voltage:
 - Three-phase version (T) 400V-3Ph
 - Single-phase version (M) 230V-1Ph
- Frequency: 50Hz
- Air flow from motor to impeller, position A (FMG).

ACCESSORIES

- Shutter gravity (SG).
- Impeller side protection grid (PG-P).
(Necessary for use in free air).
- Spacer (SP).
- Service switch (SW).

ON REQUEST

- Versions without motor side grid.
- Versions with die-cast aluminum blades.
- Explosion proof versions (PLATE-Atex).
- Versions with air flow from impeller to motor, position B (FGM).

PLATE-M

PERFORMANSE - PERFORMANCES

1 mm H₂O = 9,8 Pa

Performanse prikazane na dijagramima odnose se na vazduh na temperaturi od 15°C i na nadmorskoj visini od 0 metara, a dobijene su u instalacijama tipa „B“ u odsustvu mreže i pribora.

Performances shown in the selection diagrams refer to air at 15°C temperature and 0 mt a.s.l. altitude, and they were obtained in installation type “B” with no grid nor accessories.

2 POLA / POLES (3000 RPM) MONOFAZNO / SINGLE-PHASE (1Ph-230V 50Hz)

Model Model	Brzina protoka - Flow rate (m ³ /h)	Pm (kW)	In max (A)	Mot. (H)	Lp (dB(A))
252 M	1.850	0,09	0,8	56	64
312 M	3.500	0,25	1,7	63	70

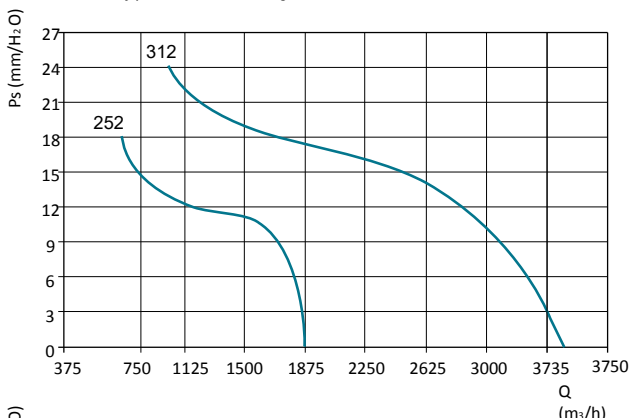

2 POLA / POLES (3000 RPM) TROFAZNO / THREE-PHASE (3Ph-400V 50Hz)

Model Model	Brzina protoka - Flow rate (m ³ /h)	Pm (kW)	In max (A)	Mot. (H)	Lp (dB(A))
252 T	1.850	0,09	0,4	56	64
312 T	3.500	0,25	0,7	63	70

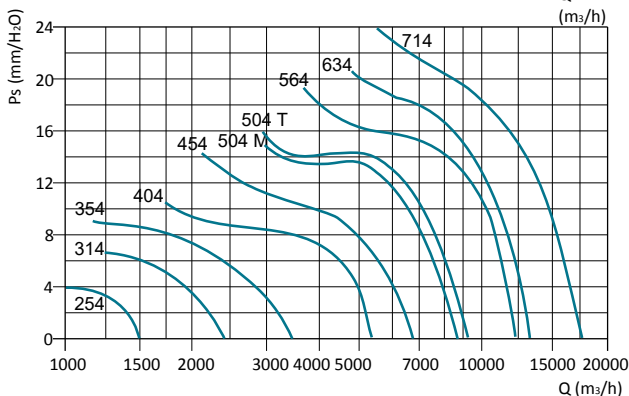

4 POLA / POLES (1500 RPM) MONOFAZNO / SINGLE-PHASE (1Ph-230V 50Hz)

Model Model	Brzina protoka - Flow rate (m ³ /h)	Pm (kW)	In max (A)	Mot. (H)	Lp (dB(A))
254 M	1.400	0,06	0,4	56	47
314 M	2.300	0,09	1	56	52
354 M	3.200	0,09	1	63	57
404 M	5.200	0,18	1,4	63	62
454 M	6.800	0,25	1,8	71	66
504 M	8.500	0,37	3,3	80	69

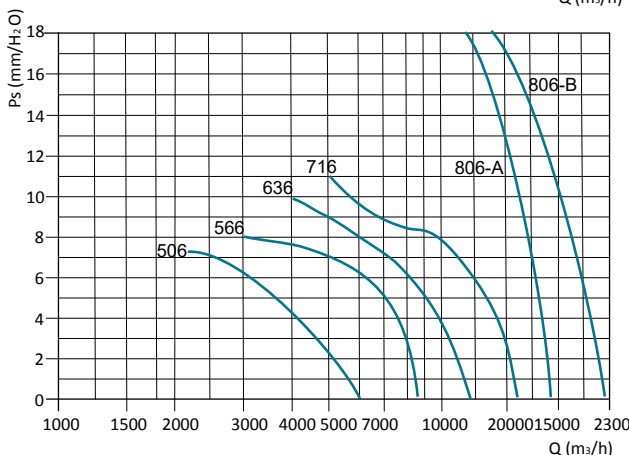

4 POLA / POLES (1500 RPM) TROFAZNO / THREE-PHASE (3Ph-400V 50Hz)

Model Model	Brzina protoka - Flow rate (m ³ /h)	Pm (kW)	In max (A)	Mot. (H)	Lp (dB(A))
254 T	1.400	0,06	0,3	56	47
314 T	2.300	0,09	0,4	56	52
354 T	3.200	0,09	0,4	63	57
404 T	5.200	0,18	0,6	63	62
454 T	6.800	0,25	0,8	71	66
504 T	9.500	0,55	1,6	80	69
564 T	12.500	0,75	2	80	72
634 T	13.500	0,75	2	80	76
714 T	17.500	1,5	3,5	90	77

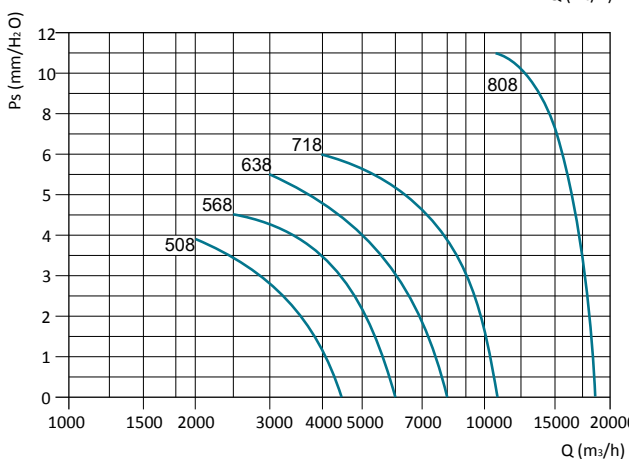

6 POLA / POLES (1000 RPM) TROFAZNO / THREE-PHASE (3Ph-400V 50Hz)

Model Model	Brzina protoka - Flow rate (m ³ /h)	Pm (kW)	In max (A)	Mot. (H)	Lp (dB(A))
506 T *	6.000	0,18	0,7	71	59
566 T	8.500	0,25	1	71	62
636 T	12.000	0,37	1,3	80	66
716 T	16.000	0,75	2,2	90	67
806/A T	19.500	1,1	3	90	69
806/B T	23.000	1,5	4	100	70

8 POLA / POLES (750 RPM) TROFAZNO / THREE-PHASE (3Ph-400V 50Hz)

Model Model	Brzina protoka - Flow rate (m ³ /h)	Pm (kW)	In max (A)	Mot. (H)	Lp (dB(A))
508 T	4.500	0,08	0,6	71	52
568 T	6.000	0,12	0,7	71	56
638 T *	8.000	0,18	0,8	80	60
718 T *	11.000	0,25	1,1	80	61
808 T *	18.200	0,75	2,3	100	63

Tolerancije: aerodinamičke performanse i buka su unutar tolerancija navedenih u DIN 24166, klasa 2
*SAMO ZA TRŽIŠTE IZVAN EVROPE
TOLERANCES: performances and sound power levels within the tolerances allowed by the DIN 24166 standard for Class 2.
*ONLY FOR-NON EUROPEAN MARKET

PLATE-M**NIVO BUKE - NOISE LEVEL**

Modello Model	63	125	250	500	1k	2k	4k	8k	Total
	Hz								
PLATE-M 252	46	55	57	57	59	55	50	40	64
PLATE-M 254	29	38	40	40	41	38	32	23	47
PLATE-M 312	52	61	63	63	64	62	56	36	70
PLATE-M 314	34	43	45	46	47	44	38	29	52
PLATE-M 354	40	48	50	51	52	49	49	39	57
PLATE-M 404	44	53	55	55	56	53	48	38	62
PLATE-M 454	48	57	59	59	60	57	52	42	65
PLATE-M 504	51	60	62	63	64	68	55	45	69
PLATE-M 506	41	50	52	52	53	50	41	36	59
PLATE-M 508	35	43	46	46	47	44	39	29	52
PLATE-M 566	44	53	55	56	57	54	48	39	62
PLATE-M 564	54	63	65	68	67	64	58	49	72
PLATE-M 568	38	47	49	50	51	48	42	33	56
PLATE-M 634	58	67	69	69	70	67	62	52	76
PLATE-M 636	48	57	59	59	60	57	52	42	66
PLATE-M 638	42	51	53	53	54	51	46	36	60
PLATE-M 714	59	68	70	71	72	69	63	54	77
PLATE-M 716	49	58	60	61	62	59	53	44	67
PLATE-M 718	43	52	54	55	56	53	47	38	61
PLATE-M 806/A	52	60	63	63	64	61	55	46	69
PLATE-M 806/B	52	60	63	63	64	61	56	46	70
PLATE-M 808	45	53	56	56	57	54	49	39	63

*Pažnja: nivo zvučnog pritiska se meri u slobodnom polju na 3 m od ventilatora, u bilo kom pravcu, sa slobodnim ulazom i izlazom.
Attention: sound pressure level is measured in free field at 3 m from the fan, in any direction, with free inlet and outlet.*

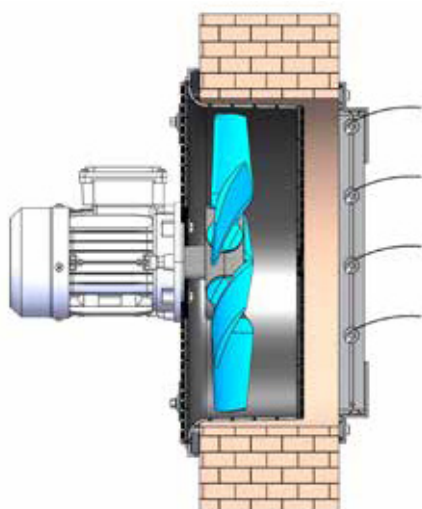
PLATE-M**NAČIN INSTALACIJE - INSTALLATION METHOD**

UGRADNA INSTALACIJA
RECESSED INSTALLATION

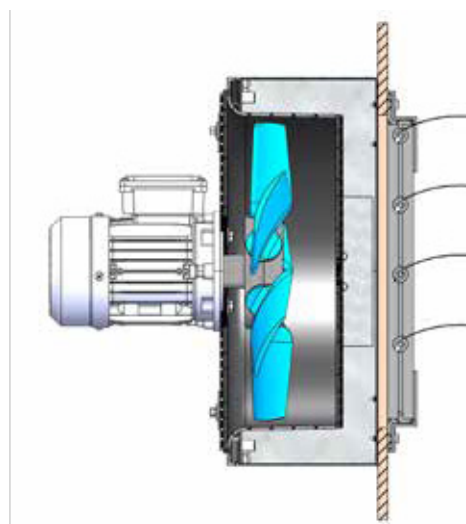

ZIDNA MONTAŽA SA MONTAŽNIM ODSTOJNIKOM
WALL INSTALLATION WITH MOUNTING SPACER

PLATE-M

DIMENZIJE - DIMENSIONS

Model Model	ØA	BxB	CxC	ØD	E	F(*)	ØG	Kg(*)
25	260	340	300	10	90	270	315	6
31	310	390	350	10	110	320	365	7
35	360	440	400	10	110	320	410	8
40	410	500	450	10	110	320	465	9
45	460	560	510	10	110	340	510	13

Model Model	ØA	BxB	CxC	ØD	E	F(*)	ØG	Kg(*)
50	510	650	580	10	110	360	570	18
56	570	700	630	10	130	380	630	22
63	640	800	730	12	130	400	700	25
71	710	850	800	12	130	460	770	33
80	810	950	900	12	180	460	900	46

Dimenzionalne tolerancije u ± 5 mm - Dimensional tolerances ± 5 mm

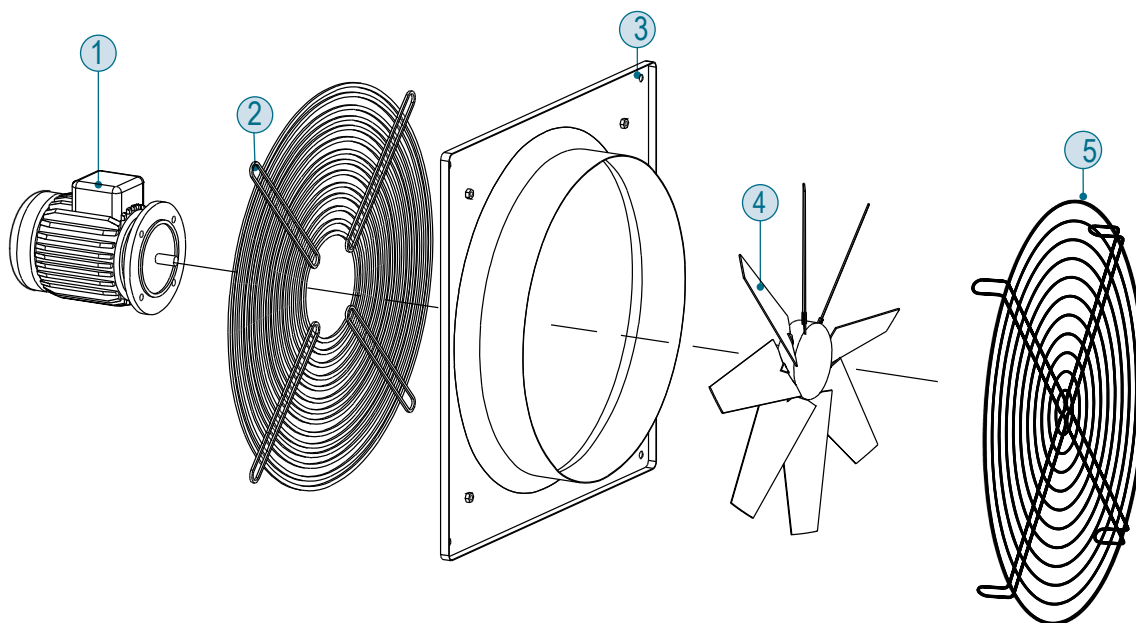
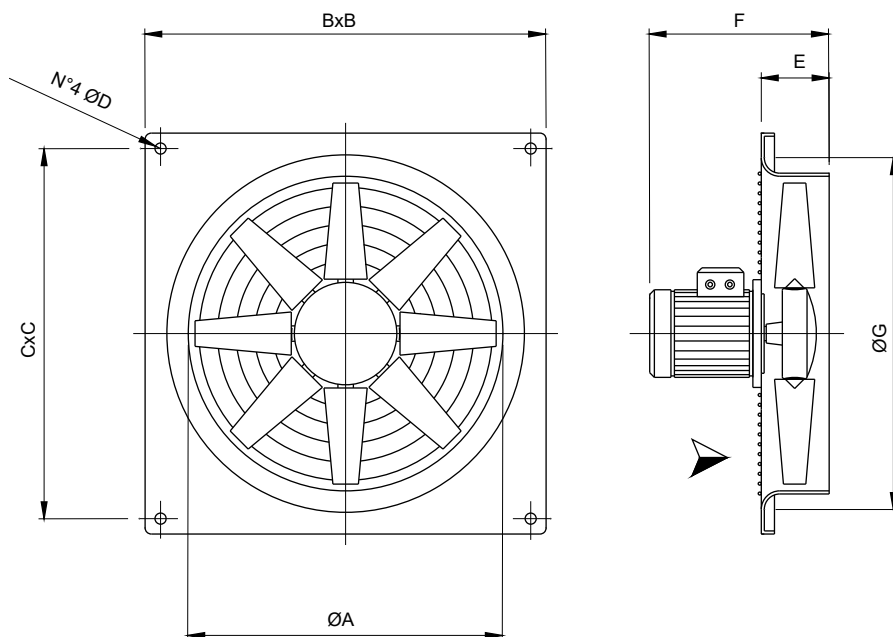

- 1 Motor - Motor
- 2 Mreža za nosač motora (opciono) - Motor support grid (optional)
- 3 Panel - Plate
- 4 Rotor - Impeller
- 5 "Dodatna" bočna mreža radnog kola (obavezna za slobodan vazduh) - Grid impeller side "accessory" (mandatory for free air)

PLATE

PRIBOR - ACCESSORIES

SG e SG-HP: GRAVITACIONI ZATVARAČ

Poklopci zatvarača se otvaraju kretanjem vazduha sa uključenim ventilatorom i zatvaraju gravitacijom kada je isključen, izbegavajući gubitak toplote, ulazak kiše, vetra i ptica.

Napravljeno od plastike (SG) ili čeličnog lima i plastike (SG-HP)

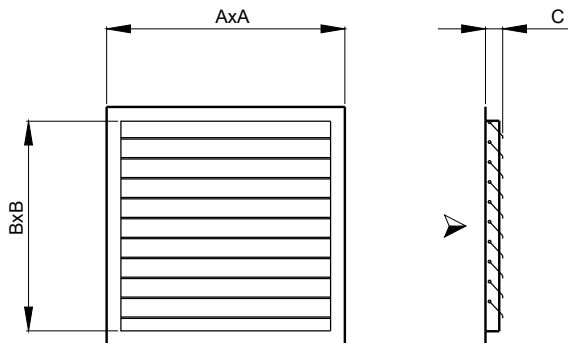

SG and SG-HP: GRAVITY SHUTTER

The fins of the shutter are opened by the air movement when the fan is operating and they shutdown by gravity when it is switched off, avoiding heat dispersions, the intrusion of rain, wind and birds.

Made in plastic material (SG) or steel sheet and plastic material (SG-HP).

Model Model	A	B	C	kg
SG 25- 31	370	300	35	0,6
SG 35	440	370	35	0,8
SG 40-45	510	440	35	1
SG 50	580	510	35	1,2
SG 56	650	580	35	1,6
SG 63	720	650	35	2,6
SG 71	785	715	35	3
SG-HP 80	920	850	25	6,8

DISTANCER: SP

Ove razmaknute priрубnice se mogu koristiti za pričvršćivanje klapne na ventilator kada zid ili ploča na koju treba da se montira ima debljinu manju od dubine mlaznice.

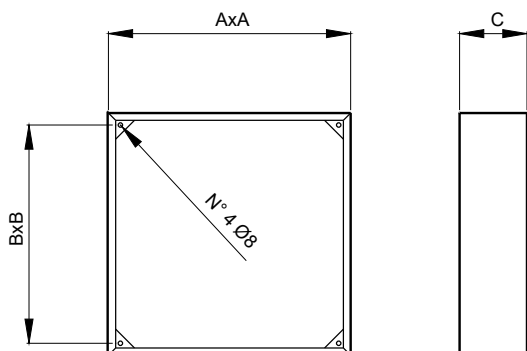

SPACER: SP

They are required to fix the shutter to the fan when the wall or the panel has a thickness lower than the height of the bell mouth of the fan.

Model Model	A	B	C	kg
SP 25	390	300	140	3
SP 31	390	350	140	3
SP 35	440	400	140	3,5
SP 40	510	450	140	4
SP 45	560	510	140	4,5
SP 50	630	580	140	5
SP 56	700	630	140	5,5
SP 63	790	730	140	6
SP 71	840	800	140	6,5
SP 80	940	900	200	9

BOČNA MREŽA RADNOG KOLA: PG-P

Koristi se za izbegavanje upada, sa strane radnog kola, ptica, glodara i sprečavanje slučajnog kontakta sa rotirajućim radnim kolom. Izrađen od elektrovarene čelične žice, u skladu sa propisima o zaštiti od nezgoda. (Neophodno za upotrebu na slobodnom vazduhu)

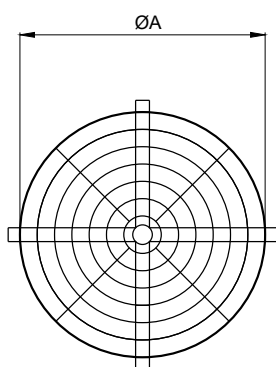

IMPELLER SIDE PROTECTION GUARD: PG-P

To be used to avoid the intrusion, from the impeller side, of birds or rats and to preserve from the casual contact with the rotating impeller. It is manufactured in steel rod according to the actual safety directive. (Necessary for use in free air).

Model Model	A	kg
PG-P 25	260	0,4
PG-P 31	320	0,6
PG-P 35	360	0,7
PG-P 40	410	0,9
PG-P 45	460	1
PG-P 50	510	1,3
PG-P 56	570	1,5
PG-P 63	640	1,8
PG-P 71	720	2,5
PG-P 80	820	3